



**London Road**  
Delapre, Northampton

**oriordanbond**  
SALES & LETTINGS



GROUND FLOOR  
613 sq.ft. (56.9 sq.m.) approx.

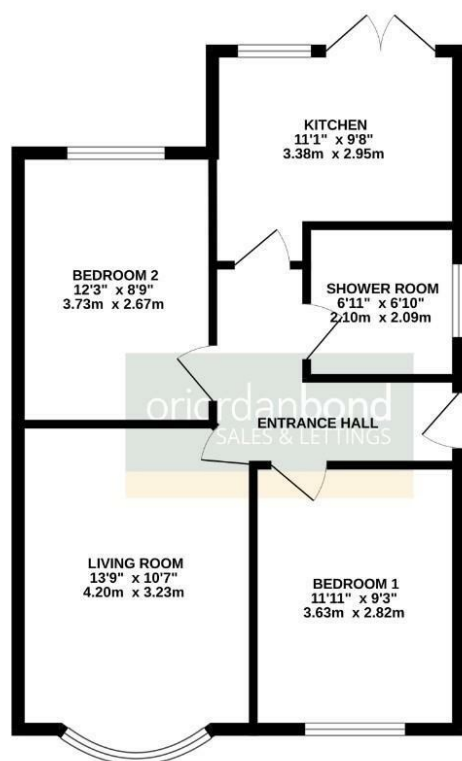

TOTAL FLOOR AREA: 613 sq.ft. (56.9 sq.m.) approx.  
Whilst every attempt has been made to ensure the accuracy of the floorplan contained here, measurements of doors, windows, rooms and any other items are approximate and no responsibility is taken for any error, omission or misstatement. This plan is for illustrative purposes only and should be used as such by any prospective purchaser. The services, systems and appliances shown have not been tested and no guarantee as to their operability or efficiency can be given.  
Made with Neoray C5025

## London Road

Delapre

NN4 8BD

OFFERS OVER £220,000

This two bedroom semi-detached bungalow with no chain is offered for sale in the very popular area of Delapre, part of NN4.

The accommodation comprises entrance hall, living room with bay window to front elevation, modern fitted kitchen/dining room, two double bedrooms and a shower room. Outside is a nice size front garden laid mainly to lawn with a selection of flower and shrubs and pathway leading to the entrance and rear garden. The rear garden has a patio area to the immediate rear with steps to a further lawned area and enclosed by timber fencing with gated side access and a single garage to the rear. Further benefits include uPVC double glazing and gas radiator heating. (C/613/M)

### Additional information

- Council Tax Band: B
- Energy Efficiency Rating: D

### Viewing

Viewing strictly by appointment – details below

### Disclaimer

O'Riordan Bond Estate Agents Limited has not tested apparatus, equipment, fittings or services and so cannot verify they are in working order. The buyer is advised to obtain verification from their solicitor or surveyor.

O'Riordan Bond Far Cotton Sales

01604 706007

farcotton@oriordanbond.co.uk

